

**REQUIRED**  
2x 

THIN TUBE 40 LED hermetic wall:

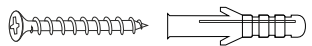

THIN TUBE 68-152 LED hermetic wall:

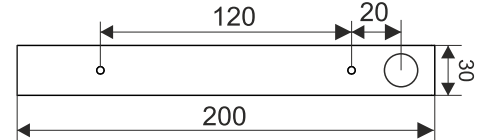
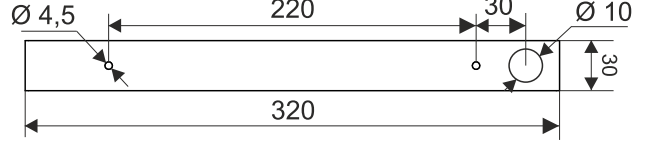

**1**

Diagram showing the preparation of the mounting bracket (I) by bending it at a 2 mm angle. The LED tube (II) is shown being inserted into the bracket.

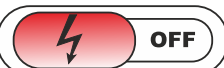
**OFF** 

**2**

Diagram showing the mounting bracket (I) being secured to the wall with screws (II). The LED tube is shown being inserted into the bracket.

**3**

Diagram showing the electrical connection of the LED tube (II) to the power supply (I) and the mounting bracket (III). The power supply is connected to the wall (IV). A circular inset shows the correct wiring connection: L (Live), N (Neutral), and a ground symbol, with a 'push' arrow indicating the correct terminal connection.

**4**

Diagram showing the final assembly of the LED tube (II) into the mounting bracket (I).

**ON** 

Źródło światła zastosowane w tej oprawie oświetleniowej powinno być wymieniane wyłącznie przez producenta lub jego przedstawiciela serwisowego, lub podobnie wykwalifikowaną osobę.  
The light source contained in this luminaire shall only be replaced by the manufacturer or his service agent or a similar qualified person.